

1 Section at Top of Stairs
A7.1 Scale: 3"=1'-0"

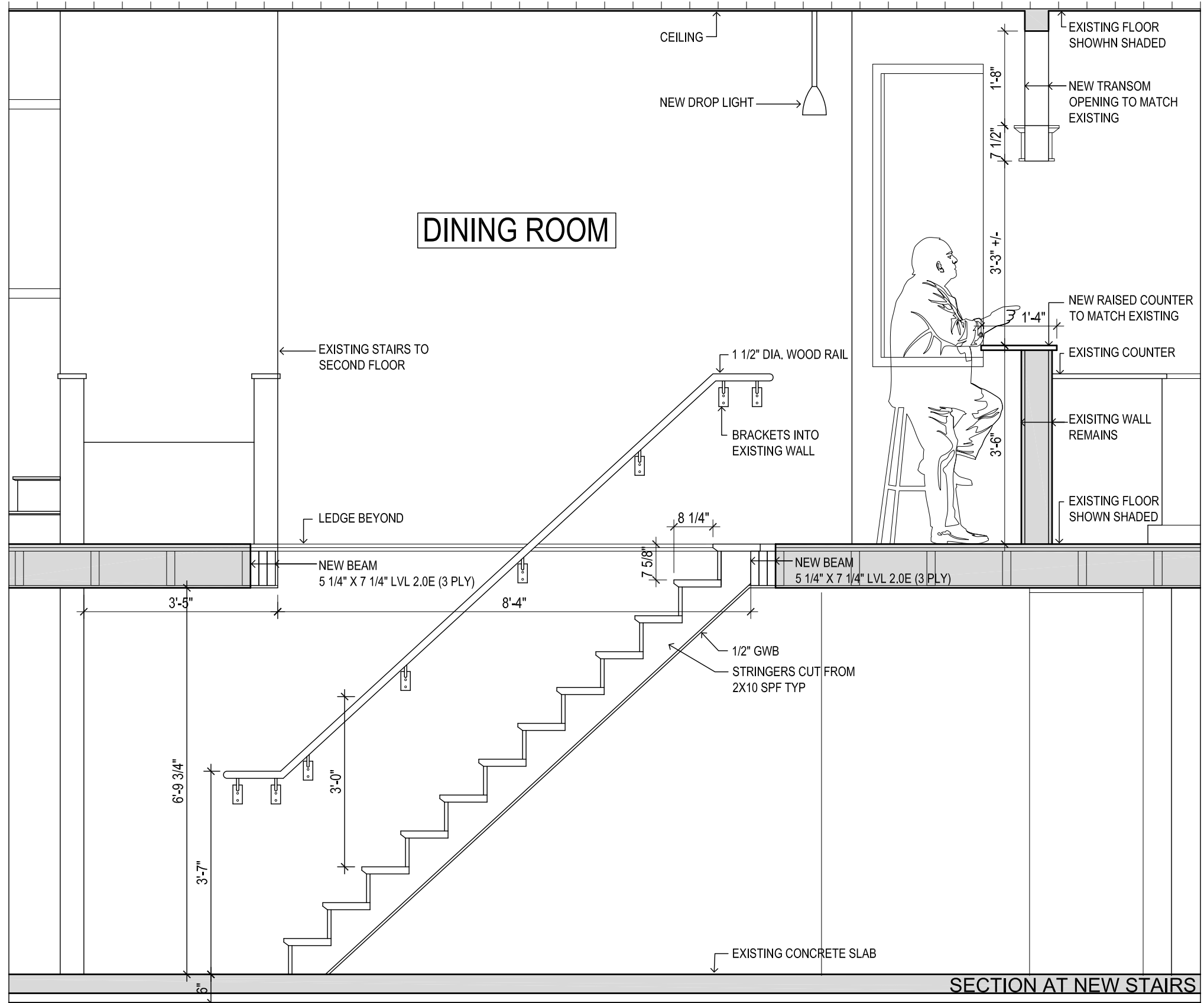

1 Section at Stairs
A7.1 Scale: 1/2"=1'-0"

jba John Boone
ARCHITECT

51 Arundel Avenue, Toronto, Ontario, M4K 3A3
Tel: 416 469 3264 Email: johnboone@rogers.com

This drawing is the Property of John Boone Architect and may be used for this project only. Scale from drawings for reference only. Dimensions to be checked and verified by the contractor on site.

523 BRUNSWICK AVE.
Toronto, Ontario

DRAWING SCALE 1/2" = 1'-0"
PROJECT DATE AUG. 2012
PROJECT NUMBER 12A09
DRAWN BY jb

PLOT DATE : January 11, 2013

No.	DATE	DESCRIPTION
1	August 18, 2012	BASE DRAWINGS COMPLETED

A7.1